

<b>Description</b>	Good value aluminium regulator of solid design.
<b>Filter element</b>	0.01 µm coalescing filter (to -04), 5 µm and 50 µm
<b>Filtration efficiency</b>	coalescing filter: 99.99% based on 0.01 µm particle size
<b>Bowl</b>	metal version with and without sight glass
<b>Drainage</b>	semiautomatic drain as standard, for max. 16 bar optionally manual drain, for max. 30 bar or automatic drain, for max. 16 bar
<b>Operating pressure</b>	max. 16 bar for metal bowl with sight glass max. 30 bar for metal bowl without sight glass
<b>Temperature range</b>	-10 °C to 50 °C / 14 °F to 122 °F for metal bowl with sight glass (-01 to -04 / -12 / -16) -20 °C to 60 °C / -4 °F to 140 °F for metal bowl with sight glass (-06 to -1A) -30 °C to 80 °C / -22 °F to 176 °F for metal bowl without sight glass
<b>Material</b>	Body: aluminium Bowl: aluminium Elastomer: NBR/Buna-N

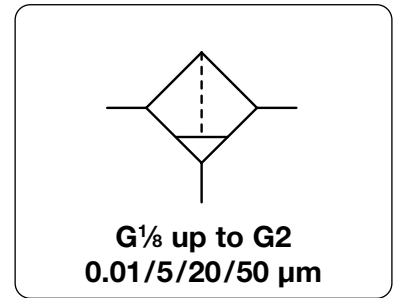

Dimensions			Bowl	Flow	Supply	Filter	Connection	Order
A	B	C	Design	Capacity	rate	element	thread	number
mm	mm	mm	made of/with	l	m <sup>3</sup> /h*1	µm	G	

Compressed air filter series "D"							with semiautomatic drain, 99.99 % at 0.01 µm		FD	
40	145	127	metal/sight glass	0.05	21	350	16	50	G <sup>1</sup> / <sub>8</sub>	FD-01MJ
					16	270		5		FD-01MG
				metal/sight glass	0.05	4		70		0.01
40	145	127	metal/sight glass	0.05	24	400	16	50	G <sup>1</sup> / <sub>4</sub>	FD-02MJ
					18	300		5		FD-02MG
				metal/sight glass	0.05	4		70		0.01
64	176	148	metal/sight glass	0.18	144	2400	16	50	G <sup>3</sup> / <sub>8</sub>	FD-03MJ
					108	1800		5		FD-03MG
				metal/sight glass	0.18	27		450		0.01
64	176	148	metal/sight glass	0.18	156	2600	16	50	G <sup>1</sup> / <sub>2</sub>	FD-04MJ
					120	2000		5		FD-04MG
				metal/sight glass	0.18	30		500		0.01
130	205	177	metal/sight glass	0.50	420	7000	16	50	G <sup>3</sup> / <sub>4</sub>	FD-06MJ
					318	5300		5		FD-06MG
130	205	177	metal/sight glass	0.50	510	8500	16	50	G1	FD-08MJ
					384	6400		5		FD-08MG



Type	D	Ø E
FD-01/02	30	4.5
FD-03/04	51	5.5

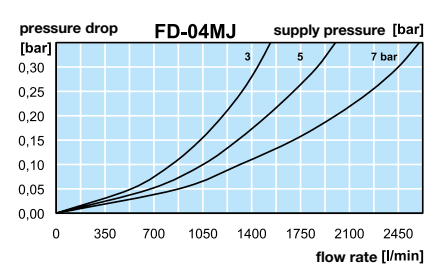
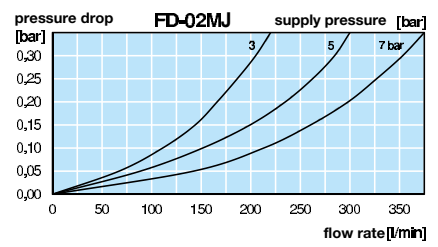
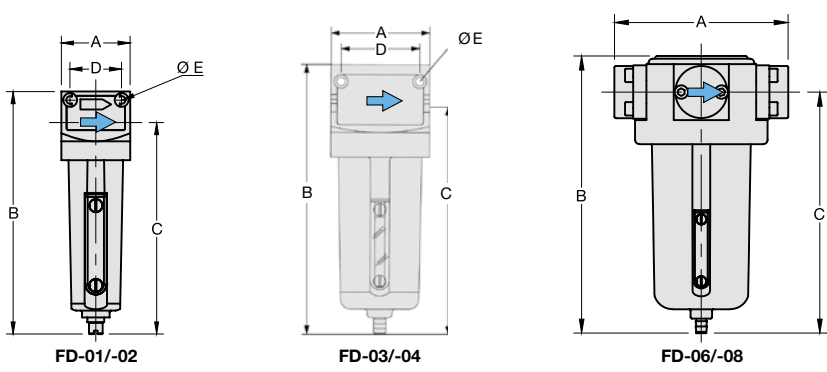

\*1 at 7 bar operating pressure and 0.33 bar pressure drop

# COMPRESSED AIR FILTER SERIES "D", UP TO 30 BAR

FD

<b>Description</b>	Good value aluminium regulator of solid design.
<b>Filter element</b>	0.01 µm coalescing filter (to -04), 5 µm and 50 µm
<b>Filtration efficiency</b>	coalescing filter: 99.99% based on 0.01 µm particle size
<b>Bowl</b>	metal version with and without sight glass
<b>Drainage</b>	semiautomatic drain as standard, for max. 16 bar optionally manual drain, for max. 30 bar or automatic drain, for max. 16 bar
<b>Operating pressure</b>	max. 16 bar for metal bowl with sight glass max. 30 bar for metal bowl without sight glass
<b>Temperature range</b>	-10 °C to 50 °C / 14 °F to 122 °F for metal bowl with sight glass (-01 to -04 / -12 / -16) -20 °C to 60 °C / -4 °F to 140 °F for metal bowl with sight glass (-06 to -1A) -30 °C to 80 °C / -22 °F to 176 °F for metal bowl without sight glass
<b>Material</b>	Body: aluminium Bowl: aluminium Elastomer: NBR/Buna-N

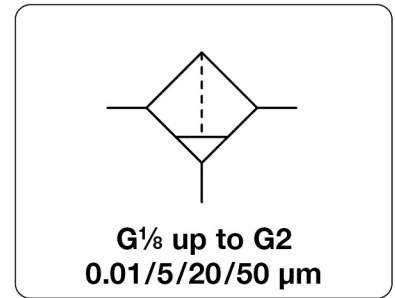

Dimensions			Bowl	Flow	Supply	Filter	Connection	Order
A	B	C	Design	Capacity	rate	element	thread	number
mm	mm	mm	made of/with	l	m <sup>3</sup> /h*1	µm	G	

Compressed air filter series "D"								with semiautomatic drain, 99.99 % at 0.01 µm	FD	
241	205	177	metal/sight glass	0.5	570	9500	16	50	G1¼	FD-10MJ
					432	7200	16	5		FD-10MG
241	205	177	metal/sight glass	0.5	600	10000	16	50	G1½	FD-1AMJ
					450	7500	16	5		FD-1AMG
215	265	223	metal/sight glass	1.2	1800	30000	16	50	G1½	FD-12MJ
				1.2	1380	23000	16	5		FD-12MG
215	265	223	metal/sight glass	1.2	1800	30000	16	50	G2	FD-16MJ
				1.2	1380	23000	16	5		FD-16MG



## Special options, add the appropriate letter

<b>operating pressure 30 bar</b>	metal bowl w/o sight glass, with manual drain	FD- . . N. H
<b>manual drain</b>	max. 16 bar	FD- . . . . H
<b>automatic drain</b>	draining through float valve, max. 16 bar for G <sup>3</sup> / <sub>8</sub> to G2	FD- . . . . R

## Accessories, enclosed

<b>mounting bracket</b>	made of stainless steel	for G <sup>3</sup> / <sub>8</sub> to G1½ (1A)	BW00-59S
	made of steel	for G1½ (12) and G2	BW00-61

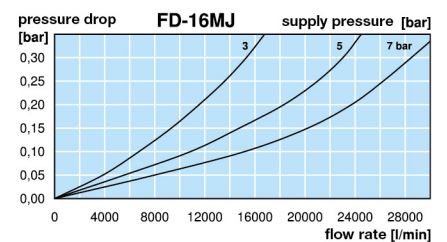
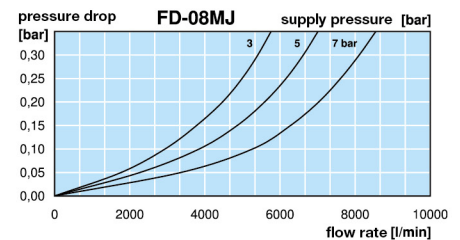
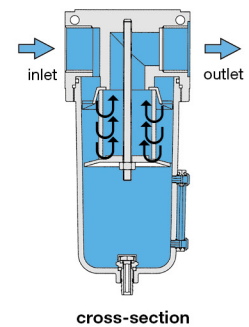
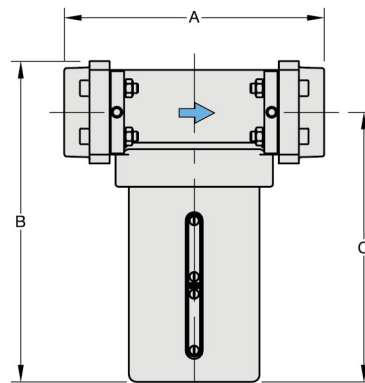
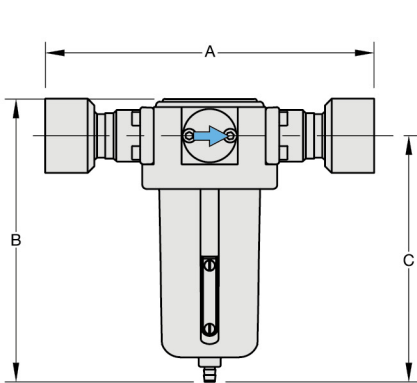

\*1 at 7 bar operating pressure and 0.33 bar pressure drop

Extensions: see chapter for FRL service units

PDF CAD  
www.aircom.net

Order example:  
FD-10MJ